

NOTE:

FOOTINGS: REINFORCED CONCRETE PER ENGINEER' OF RECORD, WITH BUTTRESS FOOTINGS OF REINFORCED CONCRETE @ 0.8 m DEPTH
WALLS: 50# EARTH BAGS, SOIL MIX INCLUDING 5-50% CLAY, 2 ROWS OF BARBED WIRE BETWEEN EACH COURSE, VERTICAL REBAR 1.2 m MINIMUM IN ALL WALLS & NEXT TO ALL CORNERS AND OPENINGS. MORTAR ANCHORS FOR BARBED WIRE 15 cm LONG MINIMUM AT ALL BUTTRESSES AND PIERS.
PLASTER: USE EARTH OR LIME PLASTER ON UNSTABILIZED EARTH BAGS CONTAINING MORE THAN 10% CLAY. USE CEMENT STUCCO ON SOILS WITH LOW CLAY CONTENT, OR ON SOILS WITH LESS THAN 15% CLAY IN FROST FREE AREAS..
WINDOWS & DOORS: WINDOW AND DOOR OPENINGS 75 cm. REBAR GRILL & SHUTTERS AT WINDOW OPENINGS, EXTERIOR DOORS TO OPEN OUT.
BOND BEAM: REINFORCED CONCRETE INTEGRAL BOND BEAM AND LINTELS 0.3 HIGH x 0.38 WIDE, TIED TO BAGS 60 cm OC WITH 60 cm #4 REBAR
ROOF: CORRUGATED METAL ON PURLINS ON RAFTERS 60 cm O.C. USE HURRICANE STRAPS TO TIE TO TOP PLATE BOLTED TO BOND BEAM.

GRISB & Earthbag Structures

Geiger Research Institute of Sustainable Building
www.grisb.org, contact: strawhouses@yahoo.com
www.earthbagstructures.com,
 contact: handshapedland@yahoo.com

SCHEMATIC PLAN

SMALL DOUBLE CLASSROOM MODULE
 LEOGÂNE, HAITI

DRAWN BY: PATTI STOUTER
 CHECKED BY: OG
 DATE: SEPTEMBER 16, 2010

▲		
▲		
▲		
#	REVISION	DATE

SCALE: 1:500
 SHEET NUMBER:

A1

FILE NAME:
 EDE Classm2

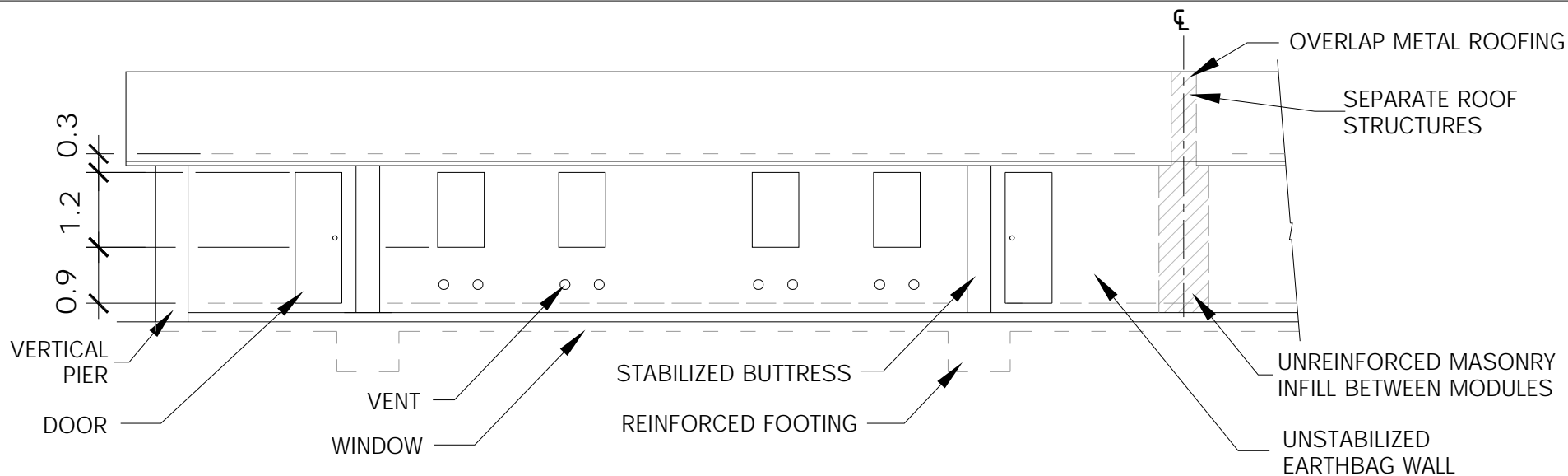

FRONT

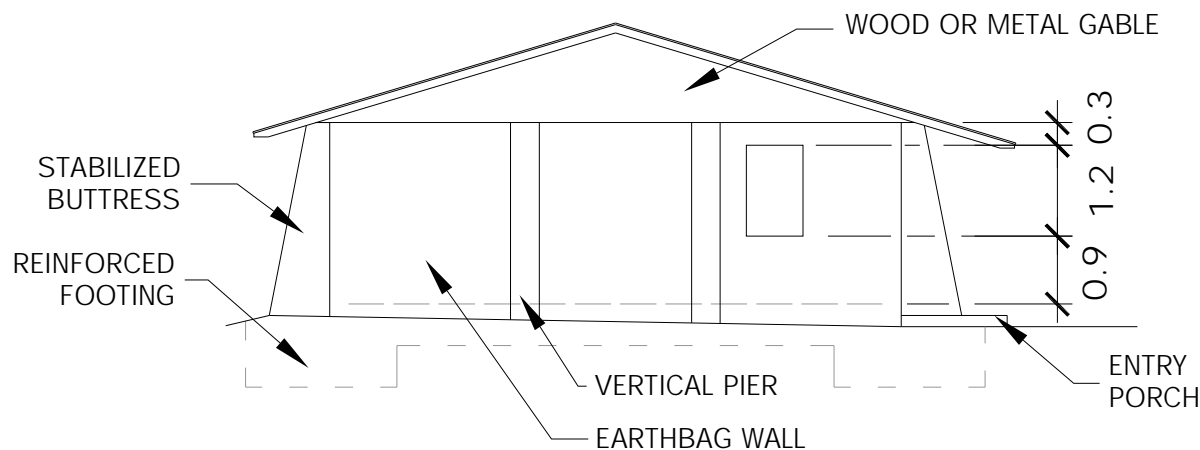

LEFT SIDE

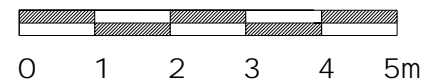

GRISB & Earthbag Structures
 Geiger Research Institute of Sustainable Building
www.grisb.org, contact: strawhouses@yahoo.com
www.earthbagstructures.com,
 contact: handshapedland@yahoo.com

SCHEMATIC ELEVATIONS
SMALL DOUBLE CLASSROOM MODULE
 LEOGÂNE, HAITI

DRAWN BY: PATTI STOUTER
 CHECKED BY: OG
 DATE: SEPTEMBER 16, 2010

SCALE: 1:500
 SHEET NUMBER:

#	REVISION	DATE
▲		
▲		
▲		

A2

FILE NAME:
 EDE Classrm2

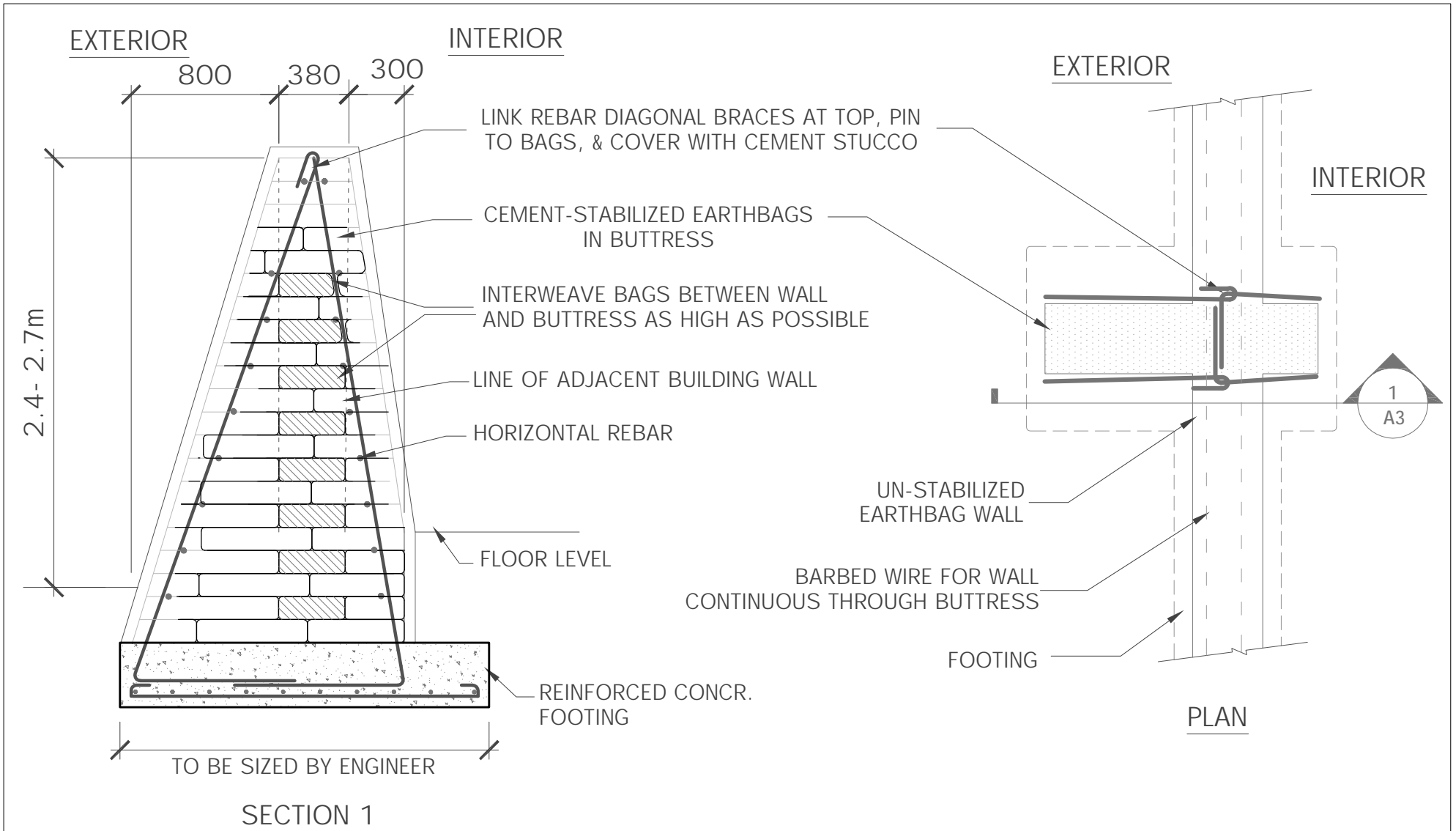

ALL NOTES ON SHEET A4 APPLY.

GRISB & Earthbag Structures
 Geiger Research Institute of Sustainable Building
www.grisb.org, contact: strawhouses@yahoo.com
www.earthbagstructures.com,
 contact: handshapedland@yahoo.com

SCHEMATIC BUTTRESS
 SMALL DOUBLE CLASSROOM MODULE
 LEOGÂNE, HAITI

DRAWN BY: PATTI STOUTER
 CHECKED BY: OG
 DATE: SEPTEMBER 16, 2010

SCALE: 1:500
 SHEET NUMBER:

A3

#	REVISION	DATE
▲		
▲		
▲		

FILE NAME:
 EDE Classrm2

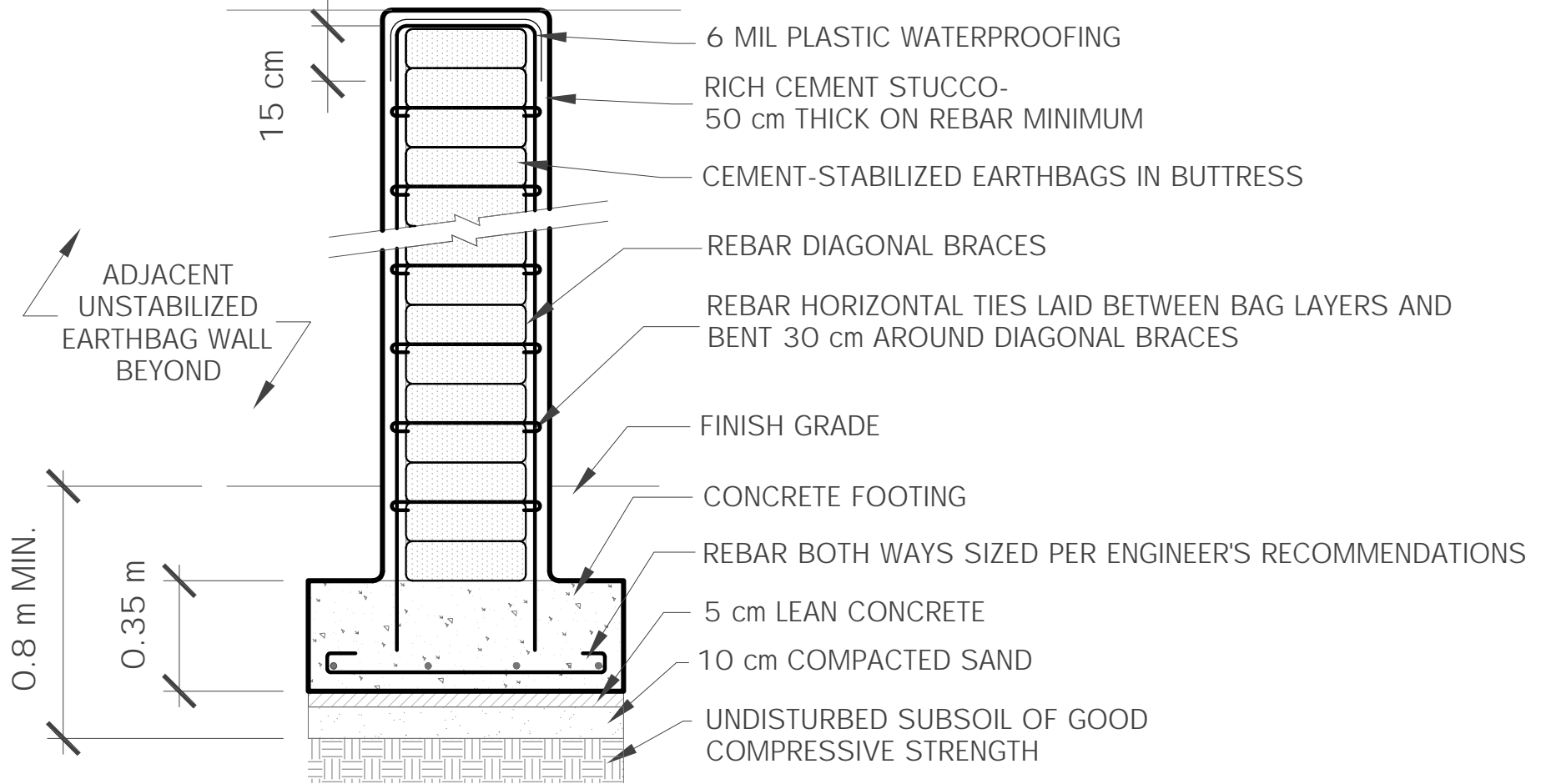

NOTES:

1. DESCRIPTION OF DESIGN AND CONSTRUCTION IS INCOMPLETE AND CONCEPTUAL, SUBJECT TO DEVELOPMENT AND MODIFICATION BY THE ARCHITECT OR ENGINEER OF RECORD.
2. REINFORCED BUTTRESSES OF BAGS WITH CEMENT-STABILIZED EARTH FILL MAY BE ENGINEERED ACCORDING TO STANDARDS APPLICABLE TO CONCRETE AND CONCRETE MASONRY CONSTRUCTION (ASTM E2392/ E2392 M/ P.5).
3. ROOF OVERHANGS 50 cm MINIMUM TO PROTECT TOPS OF EARTH WALLS.

GRISB & Earthbag Structures

Geiger Research Institute of Sustainable Building
www.grisb.org, contact: strawhouses@yahoo.com
www.earthbagstructures.com,
 contact: handshapedland@yahoo.com

SCHEMATIC

BUTTRESS DETAIL

SMALL DOUBLE CLASSROOM MODULE

LEOGÂNE, HAITI

DRAWN BY: PATTI STOUTER
 CHECKED BY: OG
 DATE: SEPTEMBER 16, 2010

SCALE: 1:500
 SHEET NUMBER:

A4

#	REVISION	DATE
▲		
▲		
▲		

FILE NAME:
 EDE Classrm2